

SOUTH SHRUBBERRY

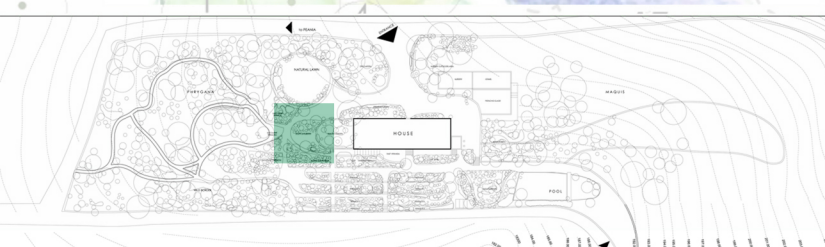

south shrubbery

- | | |
|-----------------------------------|---|
| 1 <i>Limoniastrum monopetalum</i> | 21 <i>Achillea umbellata</i> |
| 2 <i>Acanthus mollis</i> | 22 <i>Ailanthus altissima</i> |
| 3 <i>Rosmarinus repens</i> | 23 <i>Abutilon pictum</i> 'Thompsonii' |
| 4 <i>Rosa</i> sp. | 24 <i>Euphorbia myrsinites</i> |
| 5 <i>Lavandula dentata</i> | 25 <i>Ballota acetabulosa</i> |
| 6 <i>Duranta erecta</i> | 26 <i>Oxalis articulata</i> |
| 7 <i>Syringa microphylla</i> | 27 <i>Dianthus</i> sp. |
| 8 <i>Zantedeschia aethiopica</i> | 28 <i>Salvia broussonetii</i> |
| 9 <i>Iris germanica</i> | 29 <i>Convolvulus floridus</i> |
| 10 <i>Vitex agnus-castus</i> | 30 <i>Homalocladium platycladum</i> |
| 11 <i>Eriosephalus africanus</i> | 32 <i>Euphorbia cyparissias</i> |
| 12 <i>Centaurea cineraria</i> | 34 <i>Clematis terniflora</i> 'Mandshurica' |
| 13 <i>Salvia</i> sp. | 35 <i>Bougainvillea</i> |
| 14 <i>Yucca aloifolia</i> | 36 <i>Salvia microphylla</i> |
| 14A <i>Lycianthes rantonnetii</i> | 37 <i>Centranthus ruber</i> |
| 14B <i>Narcissus</i> sp. | 38 <i>Agapanthus praecox</i> |
| 14B <i>Narcissus</i> sp. | 39 <i>Euonymus japonicus</i> |
| 15 <i>Jacaranda mimosifolia</i> | 40 <i>Ruellia brittoniana</i> |
| 16 <i>Salvia discolor</i> | 41 <i>Pistacia lentiscus</i> |
| 17 <i>Ajuga reptans</i> | |
| 18 <i>Jasminum sambac</i> | |
| 19 <i>Kolkwitzia chinensis</i> | |
| 20 <i>Phlomis</i> sp. | |



project		
SPAROZA GARDEN		
OF THE MEDITERRANEAN GARDEN SOCIETY		
GOULANDRIS NATURAL HISTORY MUSEUM		
PROJECT: The existing landscape		
LANDSCAPE ARCHITECTURE PROJECT		
Design: EXISTING PLANTINGS		
SOUTH SHRUBBERRY		
PRINT PAPER	DESIGN NO	SCALE
A4		1:100
CREDITS		
<p>The current design was created as a volunteer work by Horticulturist Landscape Architect and member of the MGS Dr. Lena Athanasiadou with the aid of landscape architecture students AUTH Alexandros Mpantogias & Antonia Psaropoulou based on the plant inventory created by MGS members Sally Razelou and Marie Ruffier - Monet and hand made plans created by Ms Gennifer Gay, in 2001.</p> <p><small>Reference: Gay J. 2001 A Year at Sparoza: The Garden of the Headquarters of the MGS near Athens, Greece. Report for the RHS Buraries Committee in Acknowledgement of Financial Assistance by the Coke Trust</small></p>		
Sparoza, Peania, Athens		OCTOBER 2020